

## Connect CDT-8 to SMSL M400 DAC (with PSAudio I2S Interface)

Pin Output of I2S on CDT-8 Pro:

# NUPRIME

### Rear Panel View:

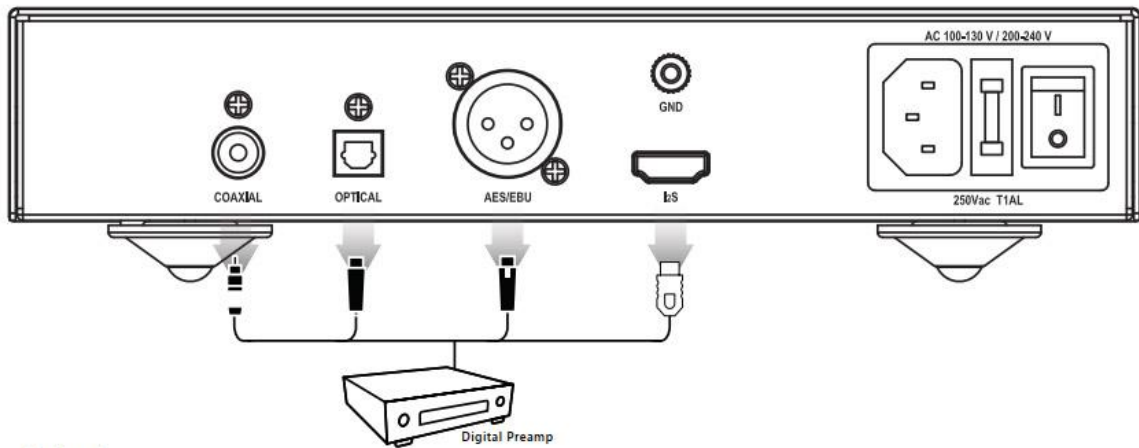

### Outputs:

1. Coaxial Output
2. Optical Output
3. AES / EBU Balance Output
4. HDMI I2S Output

### I2S PIN Define:

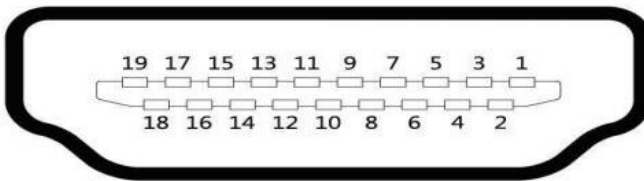

- |                  |                  |
|------------------|------------------|
| PIN 1: I2S_DATA- | PIN 10: I2S_MCK+ |
| PIN 2: GND       | PIN 11: GND      |
| PIN 3: I2S_DATA+ | PIN 12: I2S_MCK- |
| PIN 4: I2S_BCK+  | PIN 13: NC       |
| PIN 5: GND       | PIN 14: DSD ON   |
| PIN 6: I2S_BCK-  | PIN 15: NC       |
| PIN 7: I2S_LRCK- | PIN 16: NC       |
| PIN 8: GND       | PIN 17: GND      |
| PIN 9: I2S_LRCK+ | PIN 18: NC       |
|                  | PIN 19: NC       |

## Pin Layout of SMSL DAC

### 6. I<sup>2</sup>S MODE

- NORMAL
- INVERTED

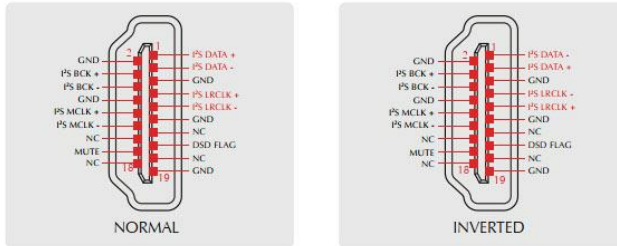

Note: This option is used to match different I<sup>2</sup>S interface standards, please check the interface definition of the signal source before use

20

### 7. I<sup>2</sup>S DSD CHANNEL

- DSDL=PCM DATA (The DSD left channel using the PCM DATA pin)
- DSDL=PCM LRCK (The DSD left channel using the PCM LRCK pin)

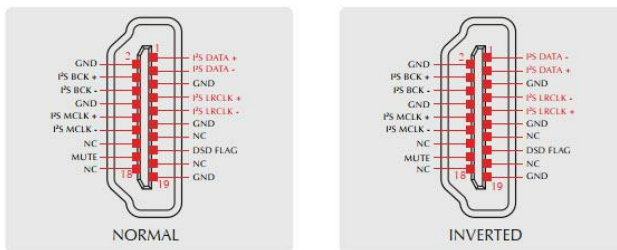

Note: This option is used to match different I<sup>2</sup>S interface standards, please check the interface definition of the signal source before use

### 8. I<sup>2</sup>S DSD FLAG

- DSD FLAG=PIN15
- DSD FLAG=PIN14



Configuration of PSAudio DAC is following:

6) I2S MODE: Inverted

7) DSD Channel: pls check which one is working

8) I2S DSD FLAG: Pin 14